

BARRIER
ROAD RUNNER
 TOTAL: 30
2M PED BARRIER
 TOTAL: 20

PARKING BAYS
SUSPENSION
AS MARKED

INITIAL GREEN TIMES (SECS)		
P1	P2	
35	35	
↙	↘	
ALL RED TIME (SECS)		
P	1	2
1	XXX	5
2	5	XXX

REFER TO 35297-D2-DIV

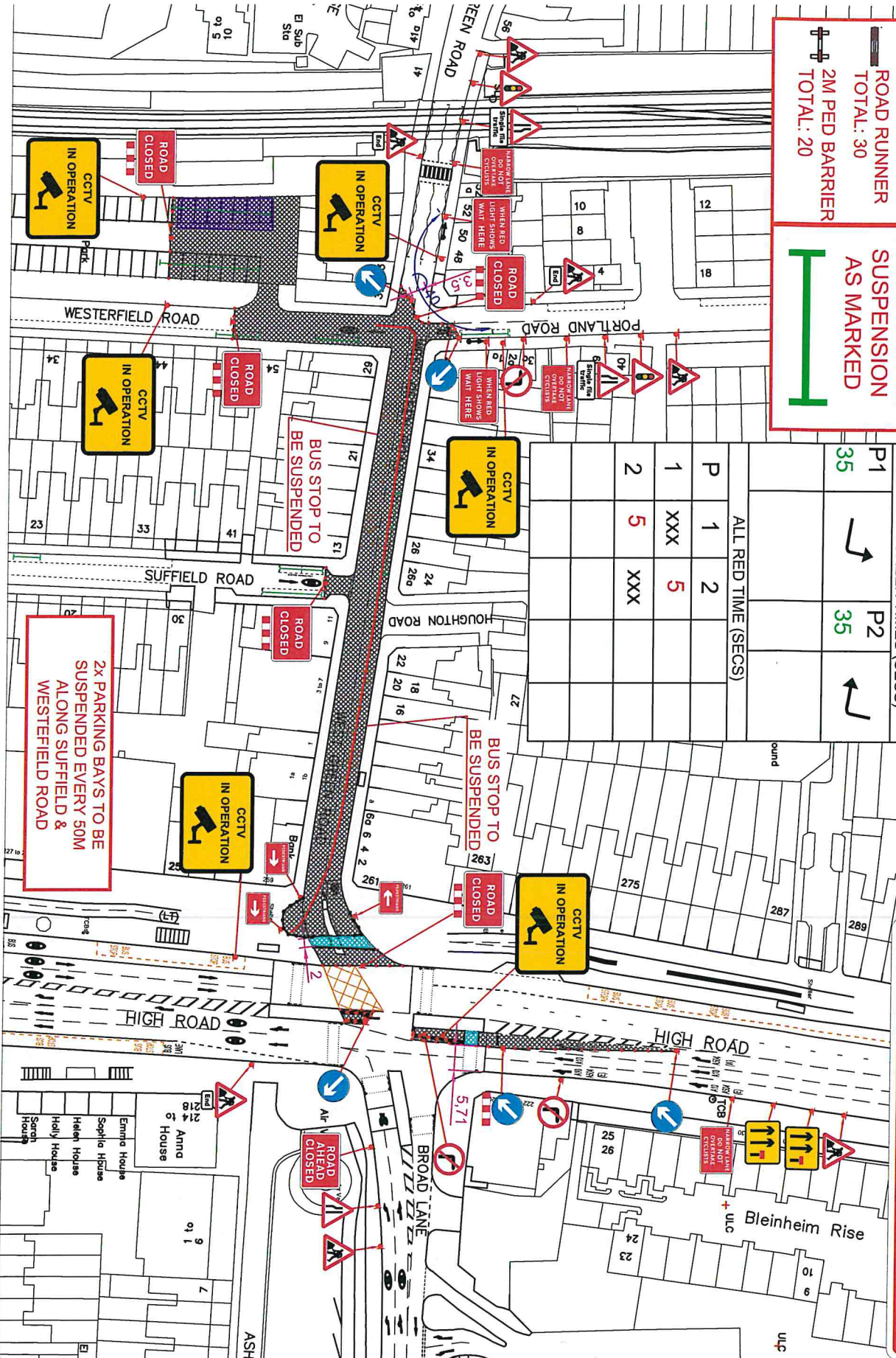

Customer:
Cadent
 Your Gas Network

Site Agent/Contact:
 Andrew Stone

Site Address:
 W Green Rd
 South Tottenham
 London
 N15 5BX



Speed of Road:

35297-D2-REV
 Date Drawn: 15.04.24
 @A3 Scale
 Drawn: LC
 Checked: RC

PRIORITY
 TM Ltd
 Traffic Management
 020 8432 8732

Traffic Management Notes

- 1) All temporary traffic management shall be in accordance with chapter 8 of the Traffic Signs Manual 2009.
- 2) All temporary traffic management shall be in accordance with the Traffic Signs Regulations and General Directions 2016
- 3) All temporary traffic management shall conform to the Safety at Street Works and Road Works, a code of Practice 2013.
- 4) All temporary traffic management signs should be located 450mm minimum from the kerb face.
- 5) All temporary traffic management sign locations are indicative and are subject to a on-site approval from the Engineer.

This drawing has been produced for the specific client and project identified below and is not intended for use by any other person or for any other purpose (e) Priority TM Ltd.
 This drawing is a representation of the traffic management systems, which must be installed by qualified personnel. Distances between signs may NOT be to scale for purposes of clarity.
 On installations, Tape Lengths, Safety Zones, Minimum Visibility to first sign & Minimum size of Signs & Cones will conform to CIPES Guidelines for the speed of the road.

KEY

- Works /Excavation
- Safety zone
- 1m Road cones
- Drob Kerbs
- Traffic Signal Head
- Pedestrian Signal
- Aspect of sign view
- Pedestrian barrier
- Pedestrian walkway
- Compound
- Road runner barrier
- No Parking Cones
- Parking Suspension

UNIT 6
 THE PLEASANT WOOD ESTATE
 STOCK ROAD
 WEST THAKINGFIELD
 CM2 8LP
 www.prioritytm.co.uk

Phone: 020 8432 8732
 Fax: 020 8305 9188
 24hr: 07973 659490
 Drawings@prioritytm.co.uk
 email: www.prioritytm.co.uk

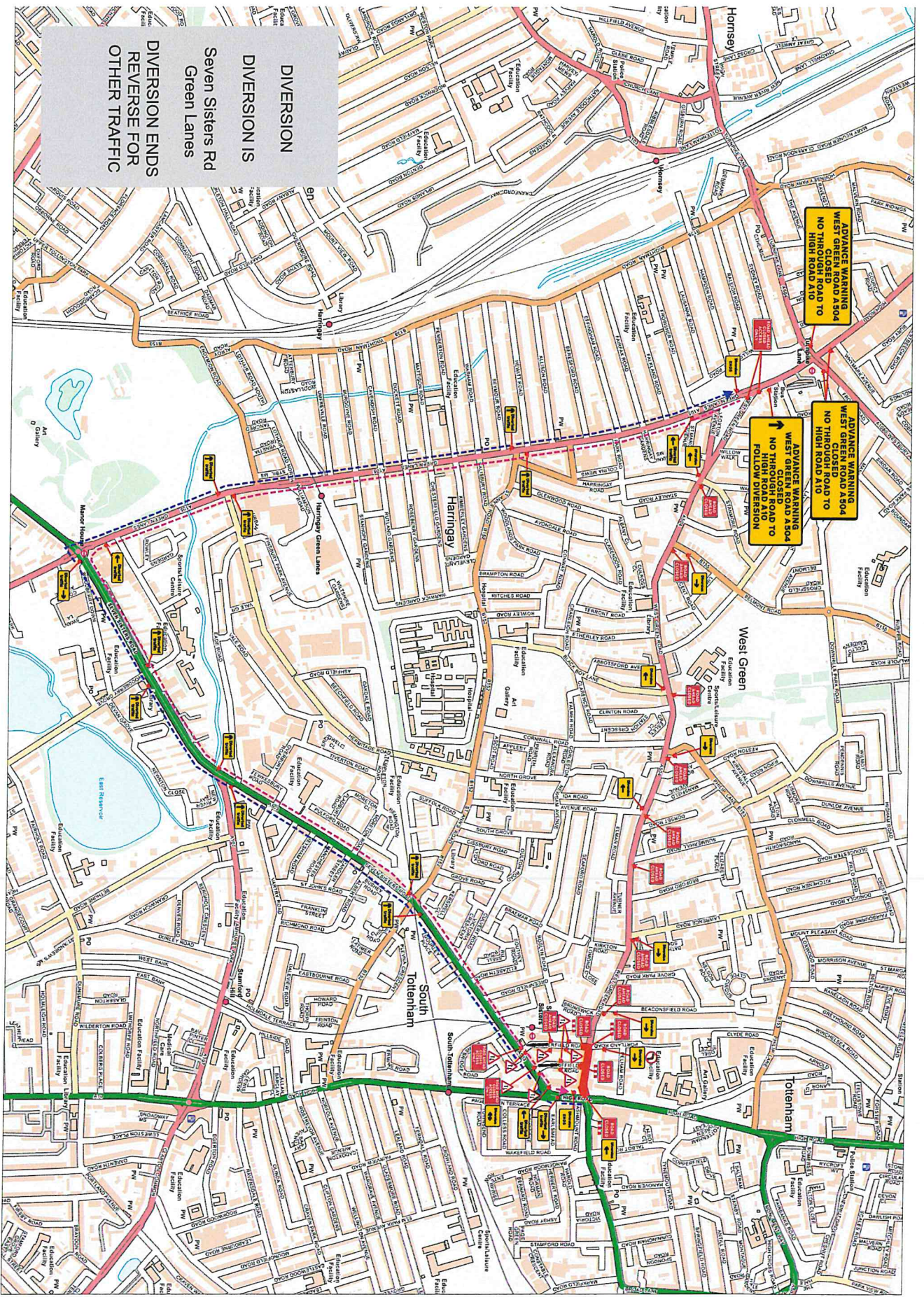

Customer:

Site Agent/Contact:

Site Address:

QR SITE

Speed of Road:



Andrew Stone

W Green Rd
South Tottenham
London
N15 5BX



35297-D2-DIV-OVERVIEW
Date Drawn: 13.03.24
Drawn: LC
Checked: RC

PRIORITY
TM Ltd
Traffic Management
020 8432 8732

UNIT 5
TEMPLE WOOD ESTATE
STOCK ROAD
WEST HANNINGFIELD
CM2 8LP
www.prioritym.co.uk
Phone: 020 8432 8732
Fax: 020 8305 9189
24hr: 07973 659490
Drawings@prioritym.co.uk

- KEY**
- CLOSURE
 - Diversion route
 - Diversion route

This drawing has been produced for the specific client and project identified below and is not intended for use by any other person or for any other purpose (c) Priority TM Ltd
This drawing is a representation of the traffic management systems, which must be installed by qualified personnel. Distances between signs may NOT be to scale for purposes of clarity.
On Installations Tape Lengths, Safety Zones, Minimum Visibility to first sign & Minimum size of Signs & Cones will conform to CIP4 Guidelines for the speed of the road.

- Traffic Management Notes**
- 1) All temporary traffic management shall be in accordance with chapter 8 of the Traffic Signs Manual 2009.
 - 2) All temporary traffic management shall be in accordance with the Traffic Signs Regulations and General Directions 2016
 - 3) All temporary traffic management shall conform to the Safety at Street Works and Road Works, a code of Practice 2013.
 - 4) All temporary traffic management signs should be located 450m minimum from the kerb face.
 - 5) All temporary traffic management sign locations are indicative and are subject to a on-site approval from the Engineer.

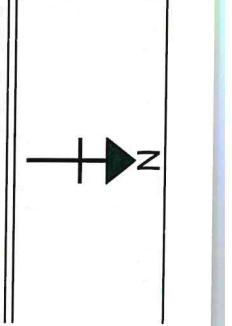

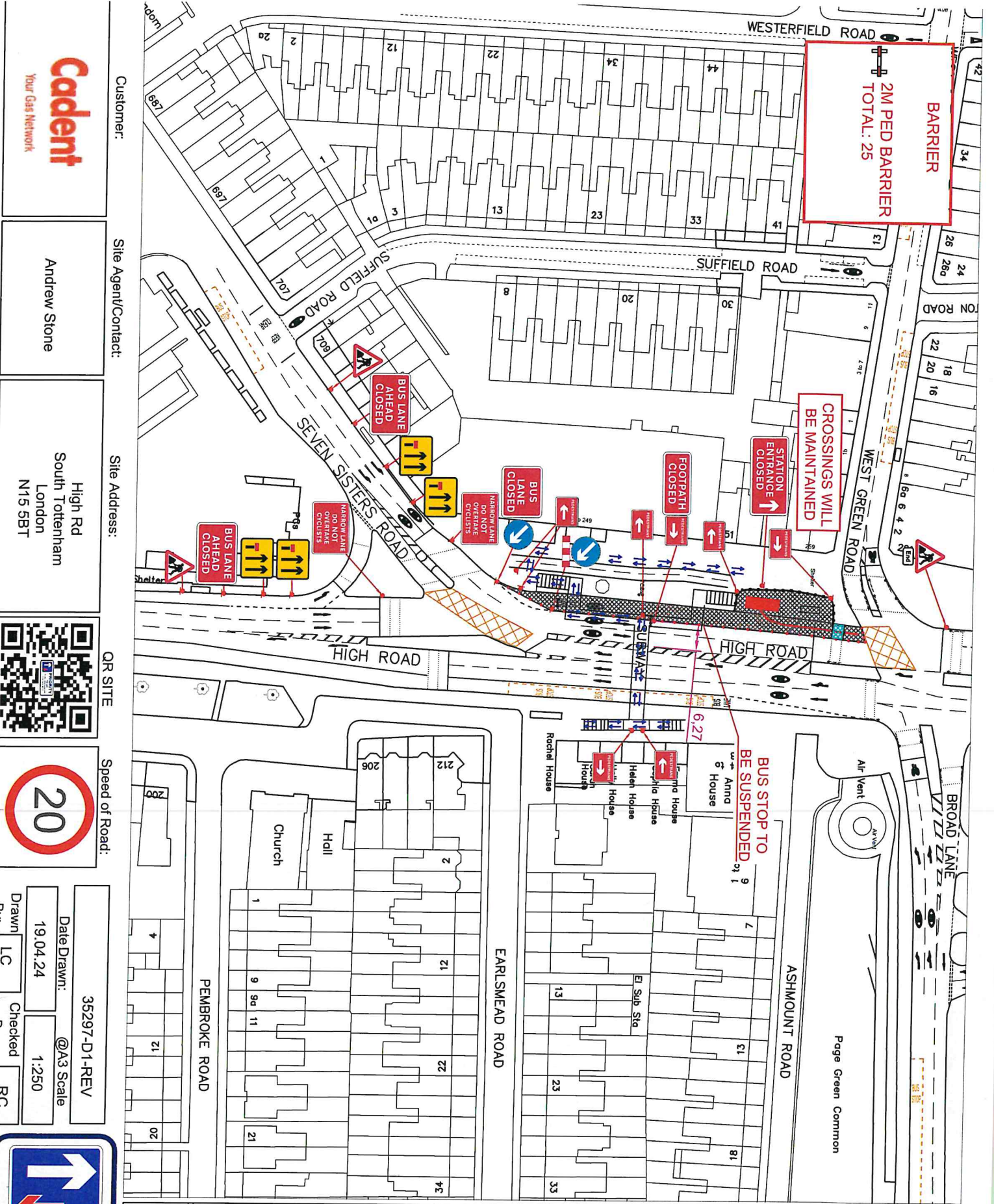

Customer:
Cadent
Your Gas Network

Site Agent/Contact:
Andrew Stone

Site Address:
High Rd
South Tottenham
London
N15 5BT



Speed of Road:
20

Date Drawn: 19.04.24
Checked: LC
35297-D1-REV
@A3 Scale
1:250
Checked: RC

PRIORITY
TM Ltd
Traffic Management
020 8432 8732

Traffic Management Notes

- 1) All temporary traffic management shall be in accordance with chapter 8 of the Traffic Signs Manual 2009.
- 2) All temporary traffic management shall be in accordance with the Traffic Signs Regulations and General Directions 2016
- 3) All temporary traffic management shall conform to the Safety at Street Works and Road Works, a code of Practice 2013.
- 4) All temporary traffic management signs should be located 450m minimum from the kerb face.
- 5) All temporary traffic management sign locations are indicative and are subject to a on-site approval from the Engineer.

This drawing has been produced for the specific client and project identified below and is not intended for use by any other person or for any other purpose. (c) Priority TM Ltd
This drawing is a representation of the traffic management systems, which must be installed by qualified persons only. Distances between signs may NOT be to scale, for purposes of clarity.
ON Installation: Taper Lengths, Stagger Zones, Minimum Visibility to first sign & Minimum size of Signs & Cones will conform to Dfipb Guidelines for the speed of the road.

KEY

- Works / Excavation
- Safety zone
- 1m Road cones
- Drab Kerbs
- Traffic Signal Head
- Pedestrian Signal
- Aspect of sign view
- Pedestrian barrier
- Pedestrian walkway
- Stop and Go sign
- Road runner barrier
- No Parking Cones
- Parking Suspension

UNIT 5
TEMPLE WOOD ESTATE
STOCK ROAD
WEST HANINGFIELD
CM2 8LP
www.prioritytm.co.uk

Phone: 020 8432 8732
Fax: 020 8405 9189
24hr: 07973 659490
email: Drawings@prioritytm.co.uk